

Location Plan 1:1250

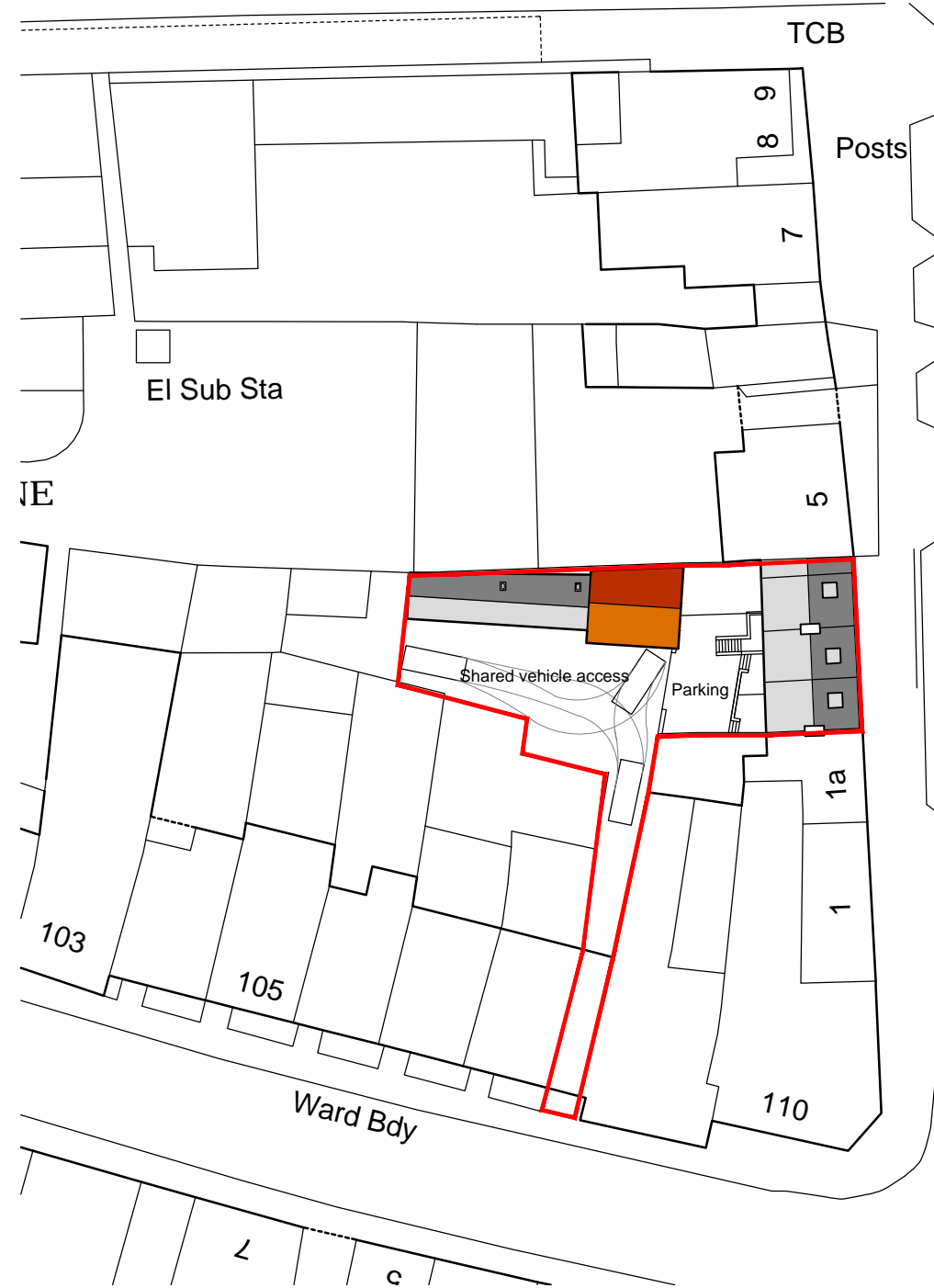

Block Plan 1:500

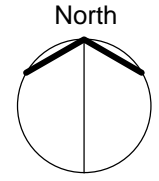
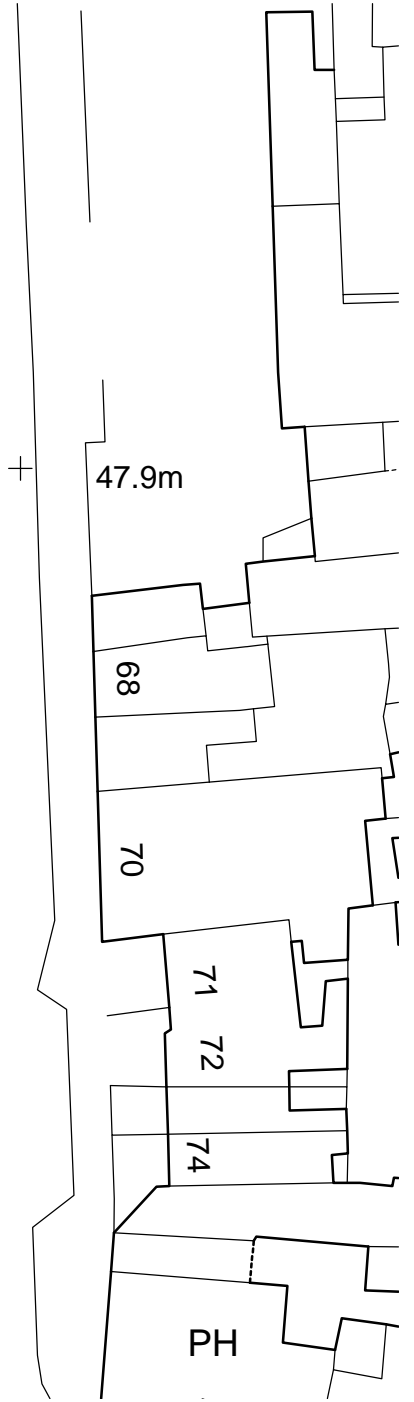

Patrick Stephenson Architects
 122 horringer road, bury st. edmunds, suffolk, ip332ee
 tel 07733 228944
 e-mail: patrick.stephenson@sky.com

Project
 No's 2-4 St. Andrews Street North and
 land to rear of No's 106-108 Risbygate
 Street, Bury St. Edmunds

Title
 Block & Location Plans

Scale	Date	Drawn	Checked
1:1250/500 @ A3	Feb 18	pat	-

Drawing No: 1181-01 Rev -